

STATIONARY CLAMPING DEVICES

MANOK plus CFK

Manual actuation stationary chuck hexagonal or round clamping geometry

Size	52, 65
Clamping range	3–65 mm

Advantages

- Made of carbon fiber
- As much as 60 % lighter than the standard model
- Sensitive manual clamping is possible
- Workpiece stabilization through axial draw force applied against the workpiece end-stop
- Ideal for 5-sided machining
- Adaptation devices possible [modular system]



Clamping elements



Clamping head SE



Clamping head RD

Adaptations

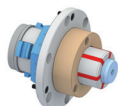

MANDO Adapt T211 SE / RD
[Mandrel-in-clamping-device, with draw bolt]

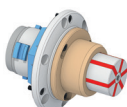

MANDO Adapt T212 SE / RD
[Mandrel-in-clamping-device, without draw bolt]



Jaw module SE / RD
[Adaptation for jaw clamping]



Magnet module SE / RD
[Adaptation for magnetic clamping]